

Set in historic Hingham, Massachusetts, the project consists of an addition and renovation to the Church's 1960 structure. The congregation expressed a need for expanding the sanctuary and narthex spaces, augmenting the social hall, and providing classrooms and a nursery for Sunday school. The design team decided to locate the nave, narthex, and sacristy in a new structure, while renovating the existing building to house the Fellowship Hall, the church offices, and classrooms. The new massing would provide an opportunity for creating a church with a stronger "visual presence" than existed with the original structure.

The two separate structures would be joined and unified by a tower marking the entry from the parking area and the glass curtain wall marking the passageway between the two parts. The original construction was clad with painted "Texture111" plywood. The two structures are now clad with a stucco finish for ease of maintenance.



Above
View of the new sanctuary.

Left
Main entrance. Sanctuary on right, nursery on left.

Bottom Left
View of altar with cut out cross showing natural light radiating from behind.

Bottom Middle
View into baptistry with reused stained glass.

Bottom Right
Floor plan showing the new sanctuary structure below the renovated existing building.

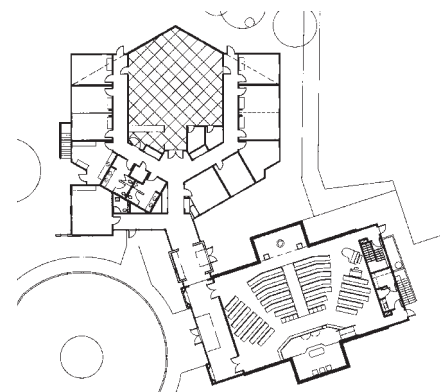
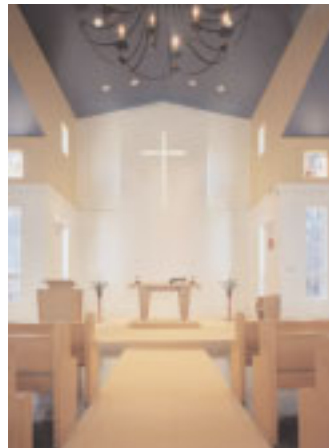

Client
**House of Prayer Lutheran Church
Hingham, MA**

Contractor
Travi Construction

Size
8,000 S.F.
(renovated and new space)

Cost
\$110 / S.F.