

The DeCordova Museum and Sculpture Park is comprised of nearly thirty acres of natural landscape and wooded parkland. The program for the new addition consists of housing the Museum's extensive permanent collection, as well as support exhibit preparation, conservancy, and receiving spaces. The new building footprint is approximately eight thousand square feet. The design retains a maximum number of trees – most of the building footprint is within an existing parking lot – and incorporates the visible stone ledge features, working with the natural slope of the land. The building mass is broken into three separate forms, using materials which reiterate the existing brick and stone of the earlier construction and the original DeCordova Mansion. A series of stone walls is incorporated in the site design, replicating those found throughout the property – especially those surrounding the original structure.

Anticipated completion date:  
Fall, 2003

Client  
**DeCordova Museum and Sculpture Park**

Contractor  
**Metric Construction**

Size  
**15,000 S.F.**

Cost  
**\$3 million**

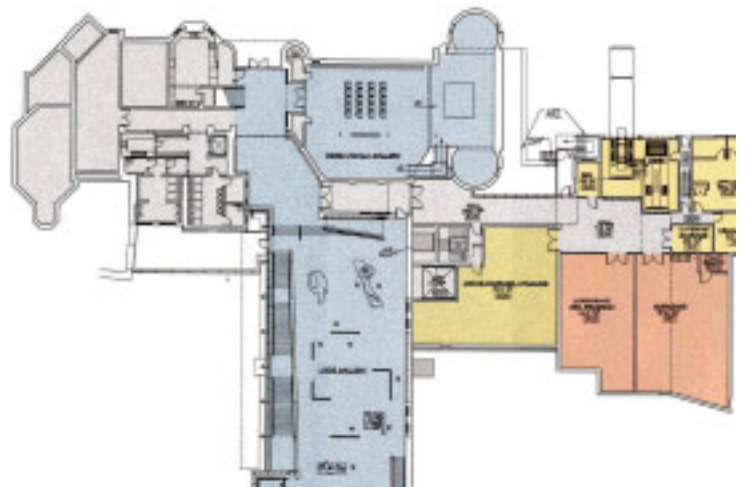

**Top**  
View from parking at the museum main entrance, addition on right.

**Above Left**  
View of addition with new exterior court nestled in the hill.

**Above Right**  
View of service and staff entry.

**Right**  
Main Floor plan with receiving, exhibit preparation and support offices.